

SANKO FRET-WIRE

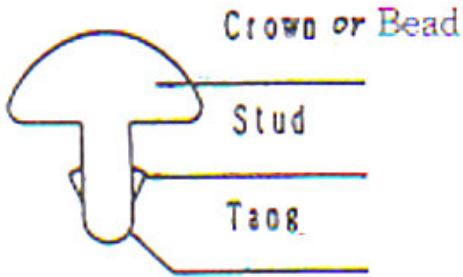

In strings instruments, fret wire greatly affects correct tuning, tone, and playability, depending on what type of “bead” or “crown” is used for the fret wire (I, e, size, shape, or hardness).

Sanko fret wires have been used by many musical instrument manufactures all over the world.

Any inquiry is welcome and we do accept special orders as for both coil and cut specifications for the fret wire.

Specification

Material; Nickel silver

Model type; See pages 2-5

Hardness ; HV-110-200 (5 Level)

Dimple spacing ; 2.5mm

Packing Specification

450~500mm (diameter) ;

30~50kg (weight) per one coil

Specification of precut fret

Since this type of fret wire is cut by our specially developed precision cutter, a cross section of this fret wire is more accurate, looks more attractive, and contributes more to efficiency compare to other products currently available, Fill out the box of page 6 (Cut specifications for the fret wire) for placing orders or inquiries.

Cut length 15-150mm

(both edges to be notched or not)

Finger board radius; 180-800mm

Model type; See pages 2~5

A special spring (coil insert) to prevent the bolt or screw from being loosening by shock is also available.



SS series

SMALL FRET WIRE

gr/m (About)

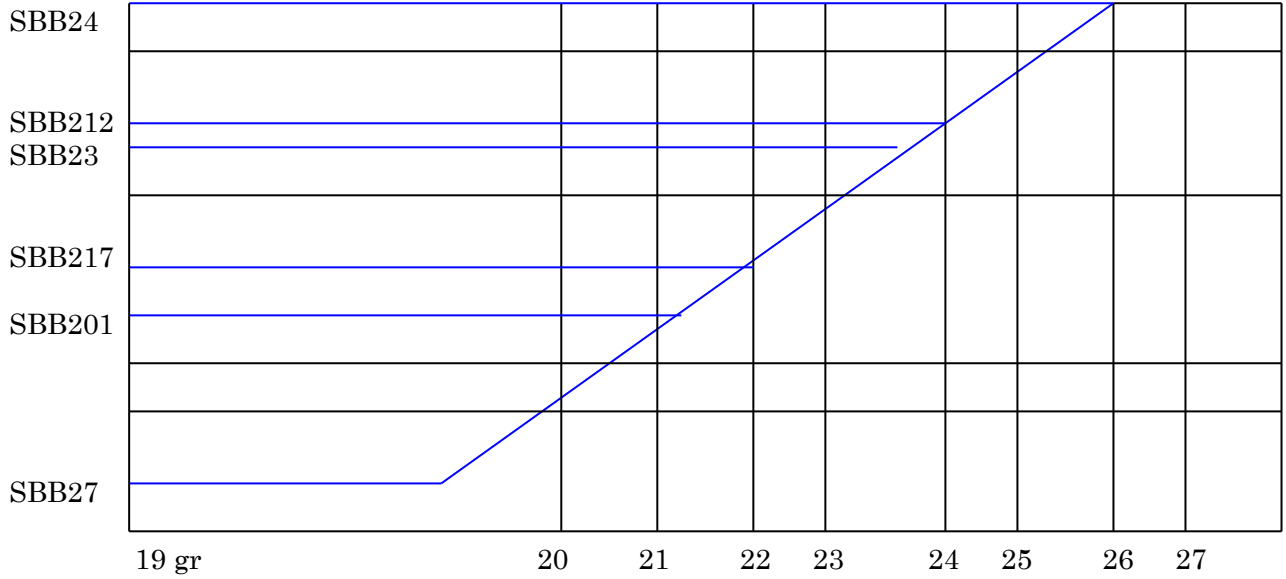

SBB

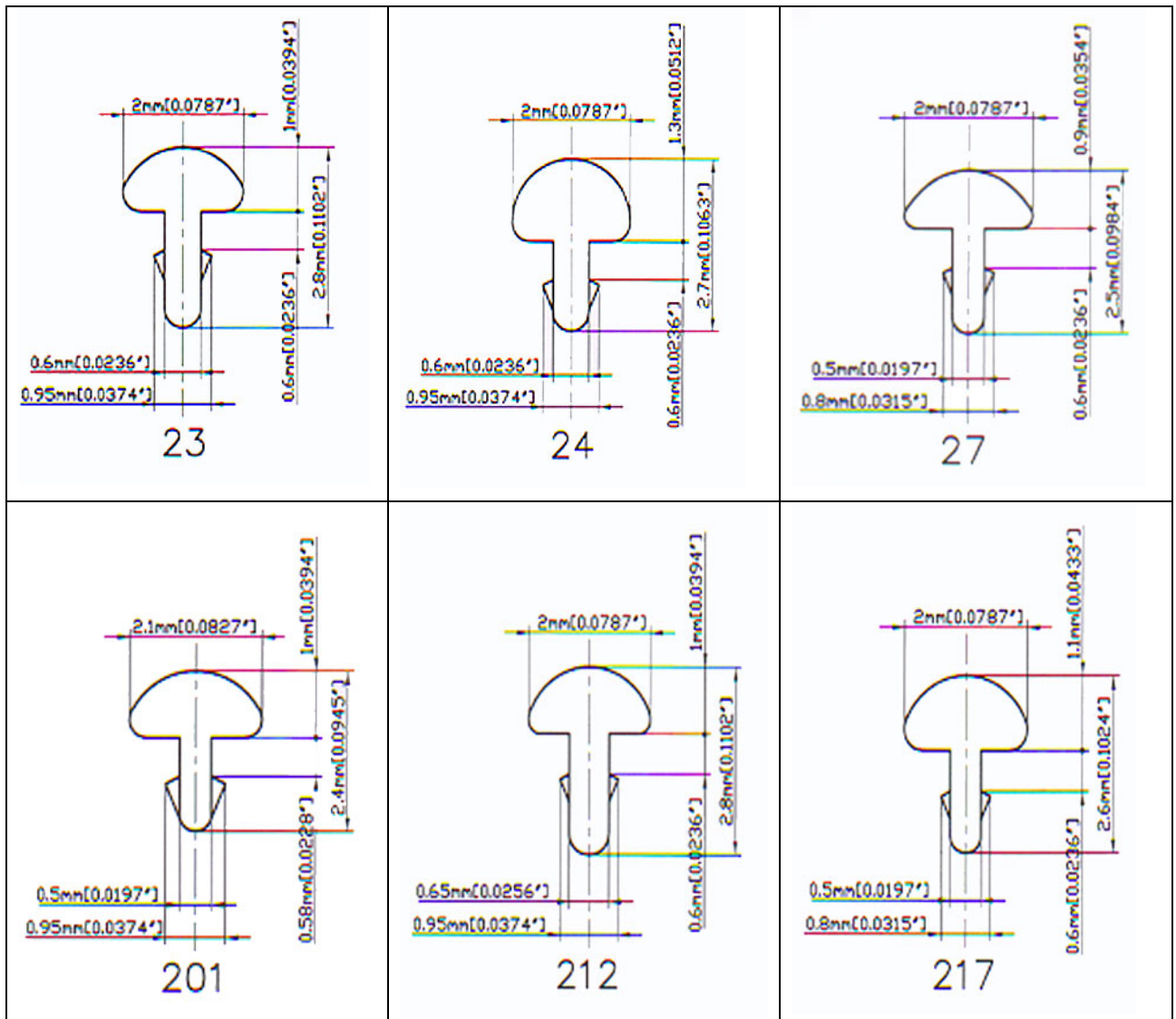

SM series

MEDIUM FRET WIRE

gr/m (About)

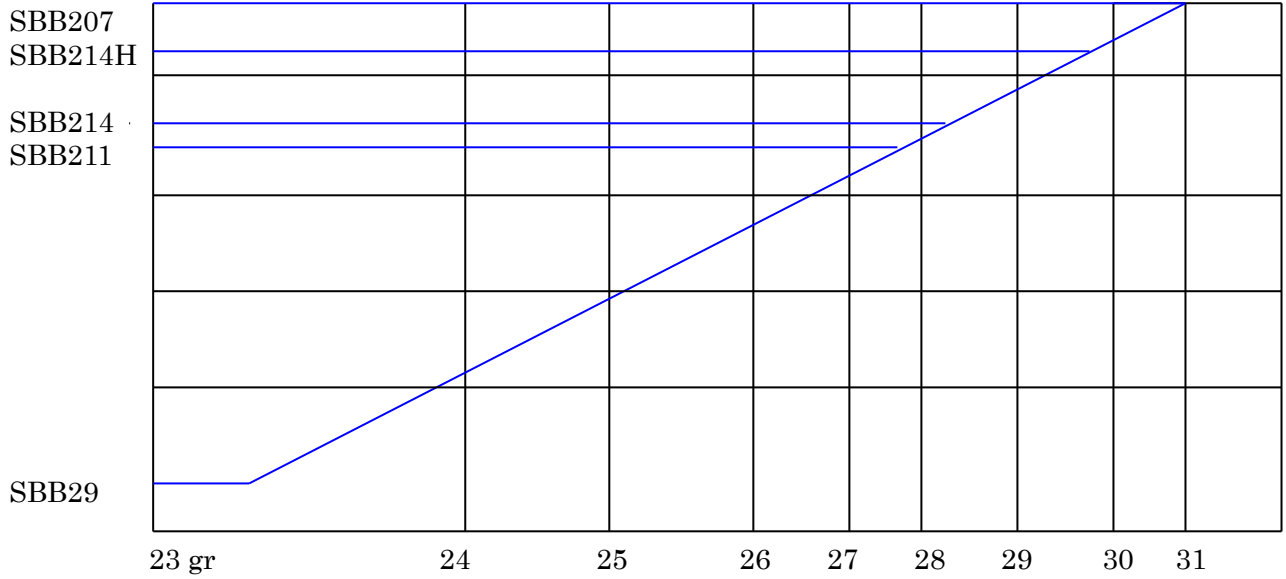

SBB

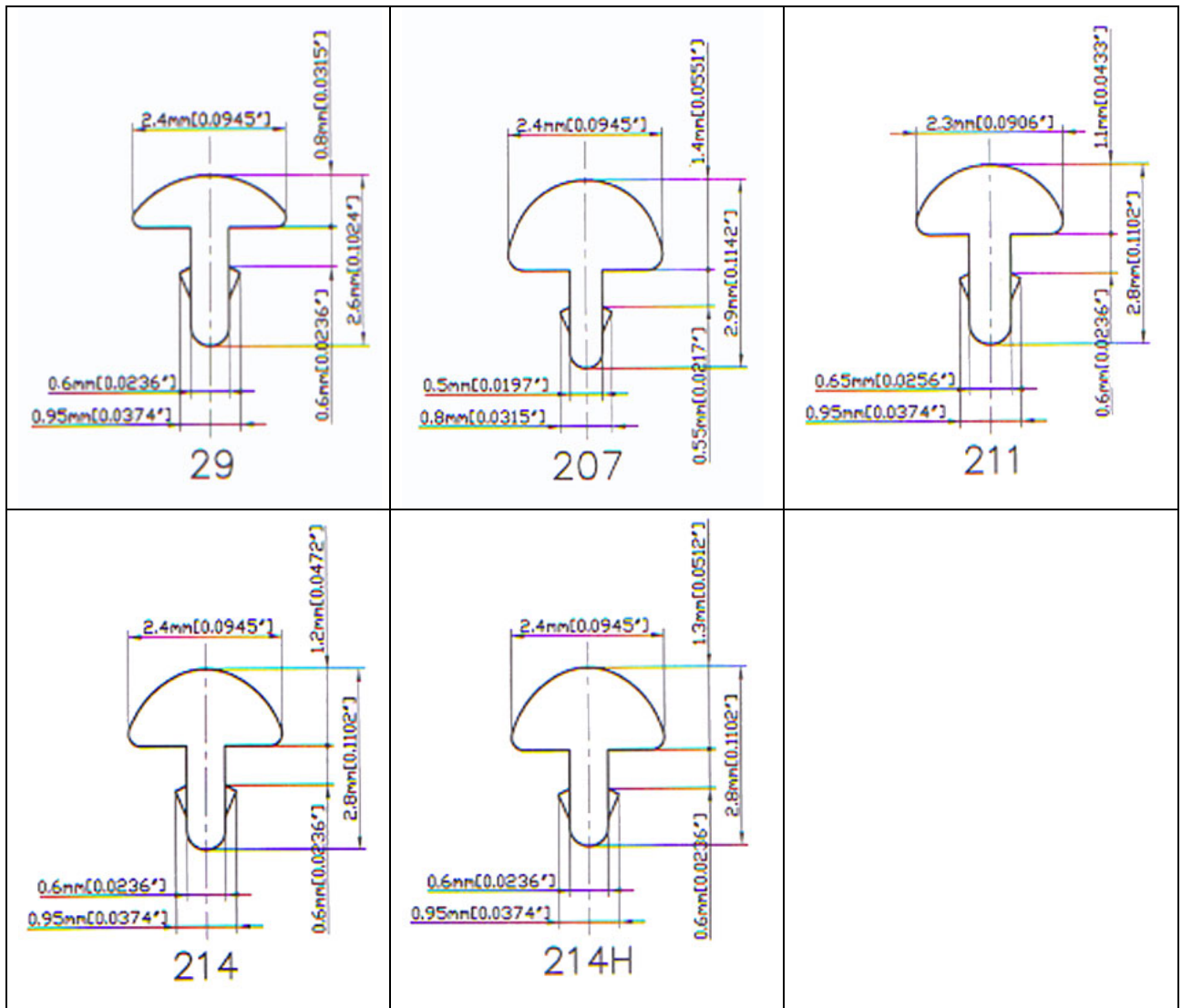

SL series

JUMBO FRET WIRE

gr/m (About)

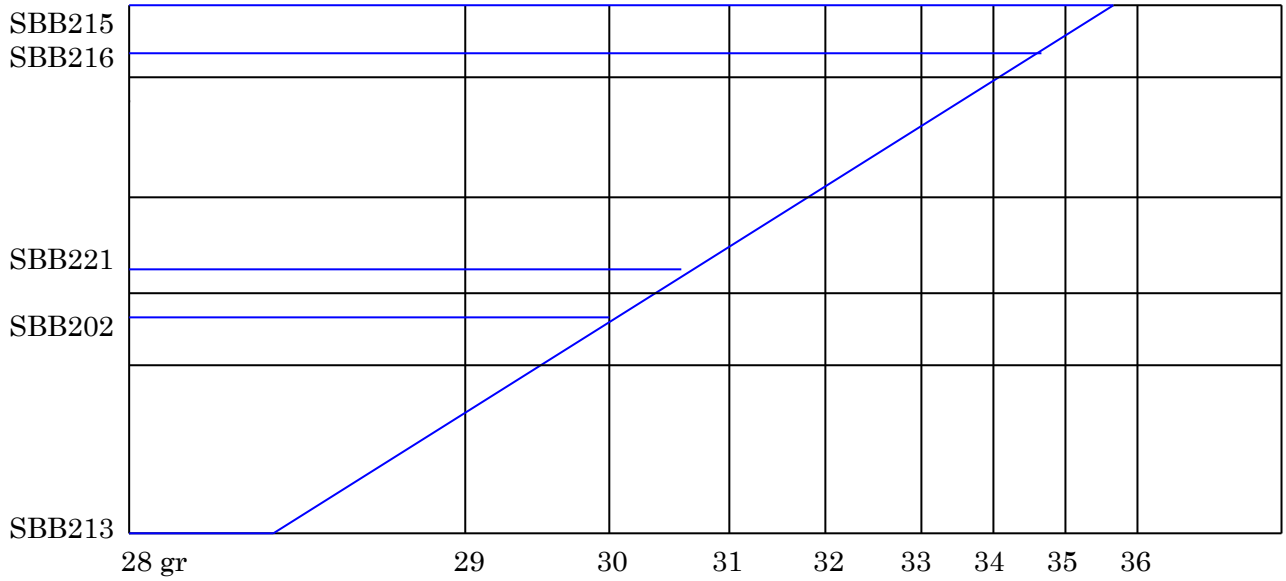

SBB

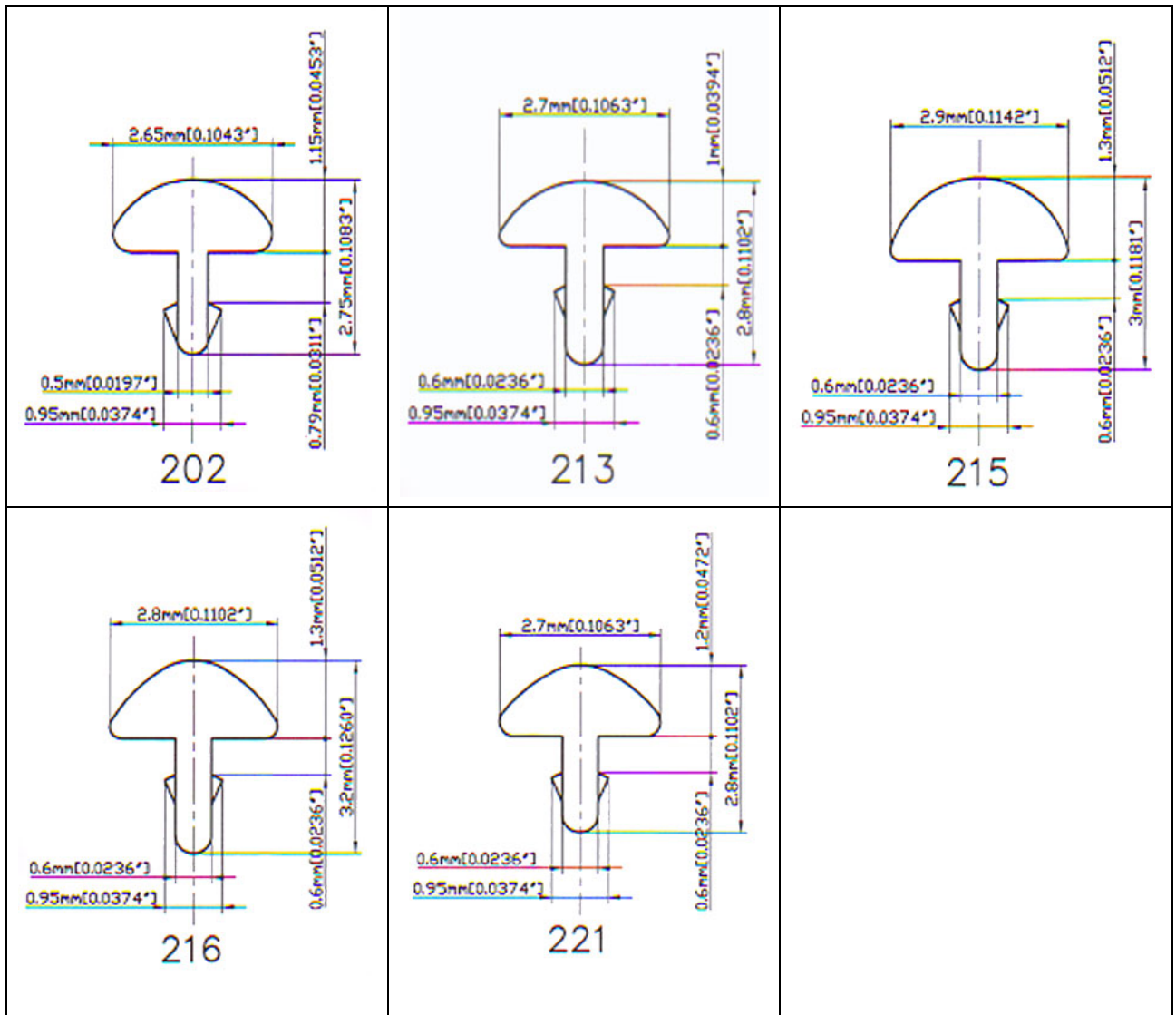

SP series

LIGHT GAUGE FRET WIRE

gr/m (About)

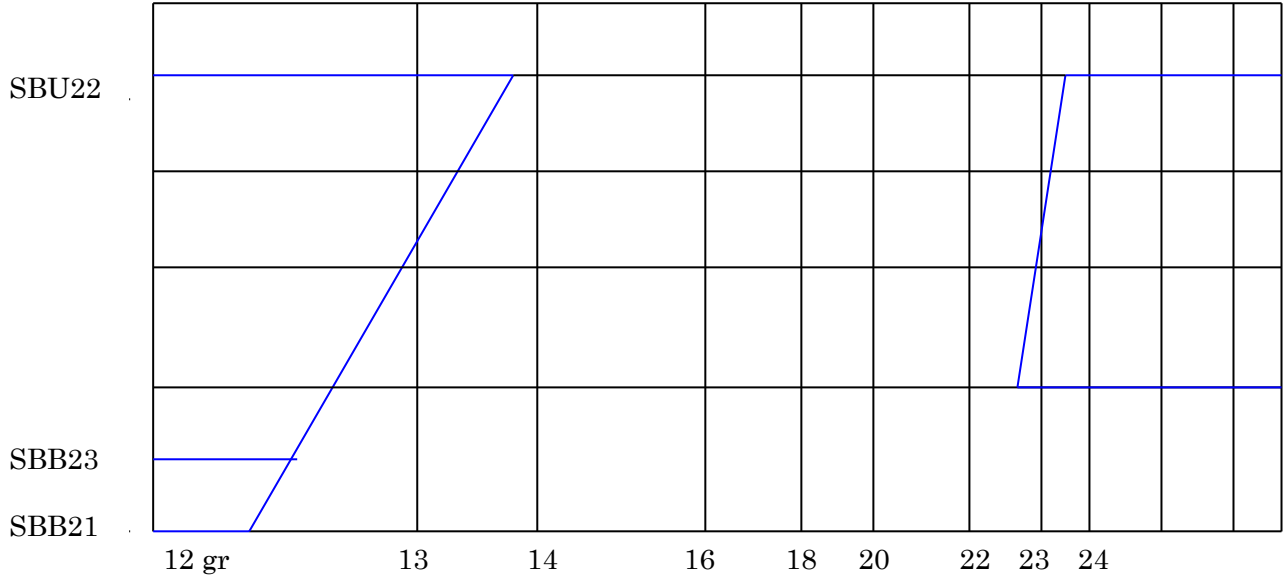

SBU

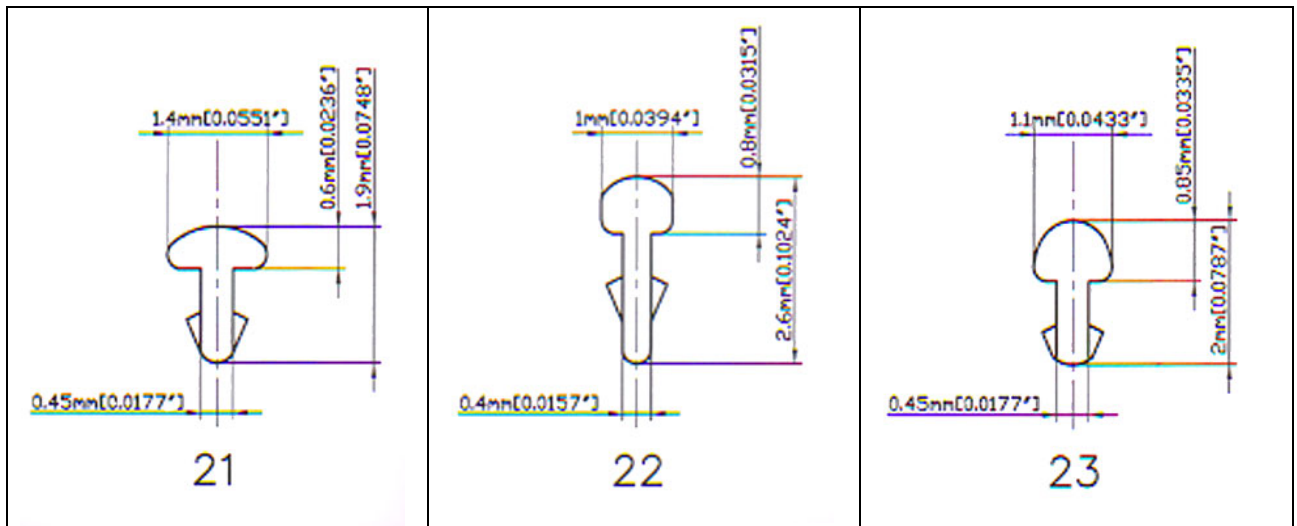

SDU

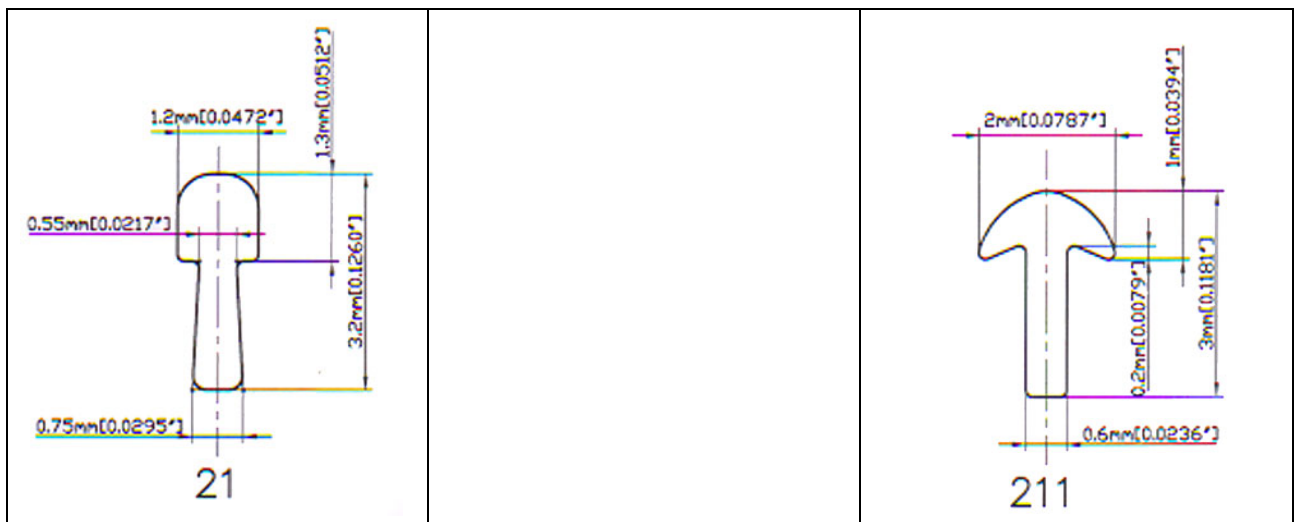

Specifications subject to change without notice

REQUESTING FORM FOR ESTIMATION OF "PRECUT"

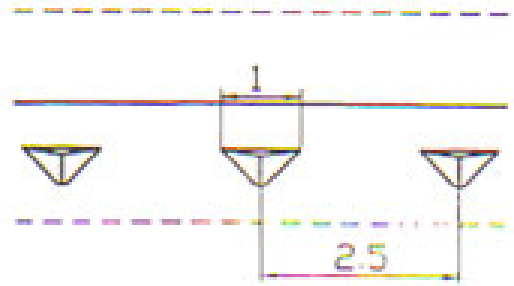
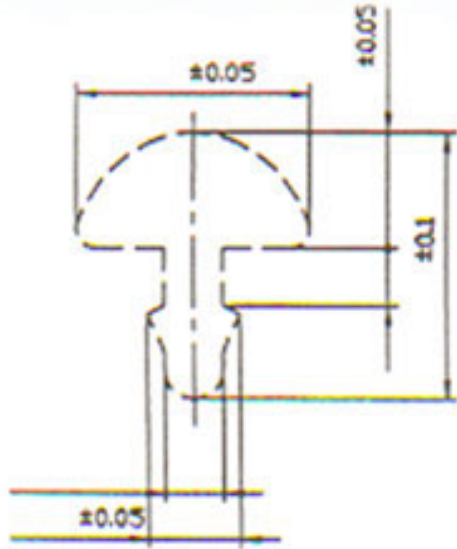

MODEL TYPE

NO.

Hardness

No.	Length	Q'ty	No.	Length	Q'ty
1			16		
2			17		
3			18		
4			19		
5			20		
6			21		
7			22		
8			23		
9			24		
10			25		
11			26		
12			27		
13			28		
14			29		
15			30		

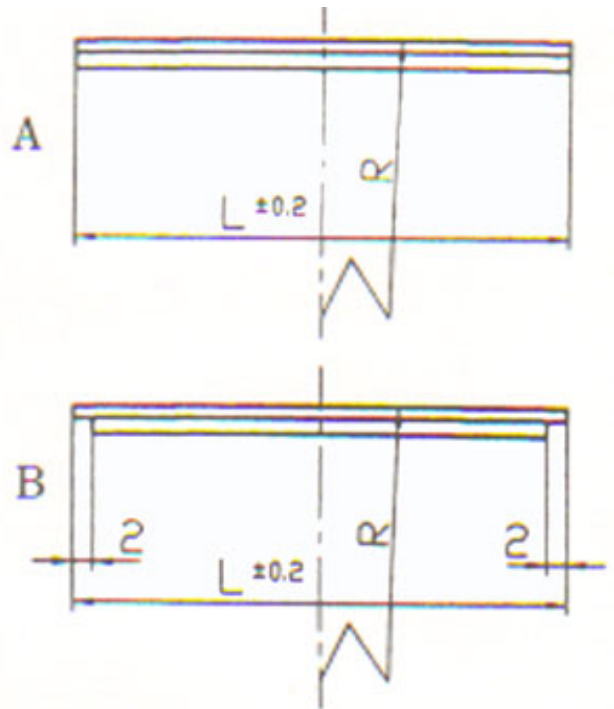

both edges to be notched or not (B) or (A)

finger, board radius

R

Name

DISTRIBUTED BY
KMS SHOKAI CO., LTD
 1-5-21-101 Honkugenuma, Fujisawa,
 Kanagawa-Pref. 251-0028, Japan
 Tel ; +81-466-55-5116
 Fax; +81-466-55-5117
 E-mail; info@kms-shokai.co